

View A

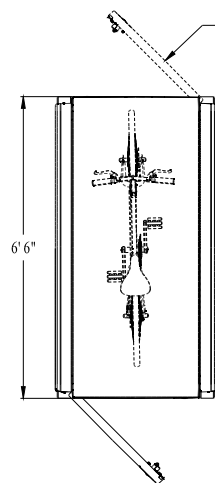

Single Unit Locker
Single Sided Access = (2) Bike
Double Sided Access = (4) Bikes
Square Footage = 23.29'

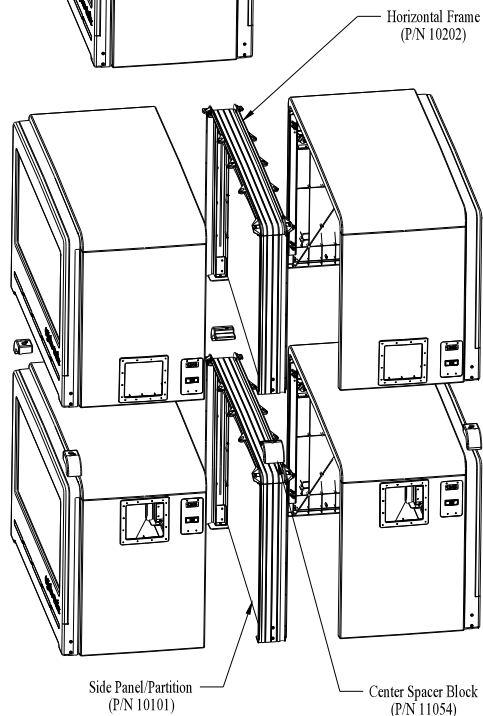
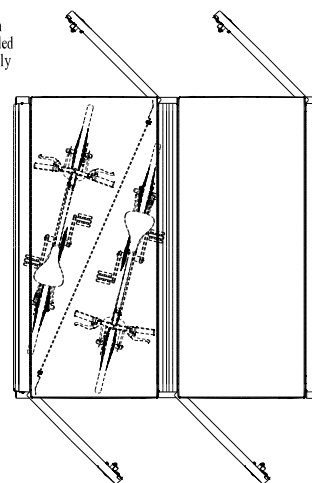

Double Unit Locker
Single Sided Access = (4) Bikes
Double Sided Access = (8) Bikes
Square Footage = 43.875'

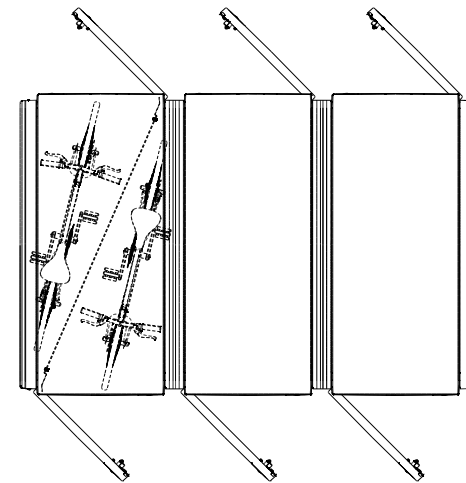

Triple Unit Locker
Single Sided Access = (3) Bikes
Double Sided Access = (6) Bikes
Square Footage = 64.46'

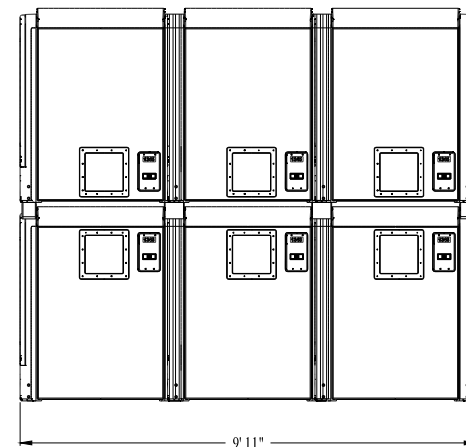
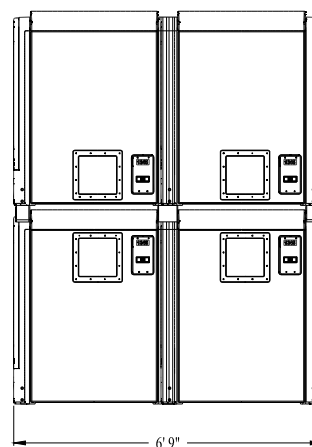
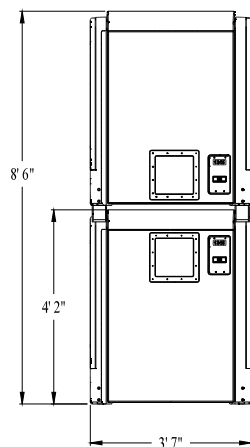

Notes: When joining Additional Locker Units; replace (1) of the End Panels with
(1) Horizontal Frame, (2) Vertical Frames "one in front and one in back",
(2) Leveling Plates "one in front and one in back", and (1) Side Panel.

The End Panel will be relocated at the "Opened End" to create a Closed Locker System.

Double Tier Lockers are placed on the top of the Bottom Locker after the proper Spacer Blocks have been secured to the Bottom Locker with the bolts provided. The Upper Tier is then secured through the Spacer Blocks using the additional hardware included.

Cycle Safe
5211 CASCADE RD SE, SUITE 210
GRAND RAPIDS, MI 49546
www.cyclesafe.com

A	RELEASE FOR PRODUCTION	00/10/13
REV	DESCRIPTION	DATE
PROPARK ~ DOUBLE TIER {DOOR-VIEW}		
REV	LOCKER CONFIGURATIONS	LS 4.1.008
D		A